



Important infos for Saco Student Fair in Malmö 2024

Hours

- Venue: [Malmömässan](#) in Hyllie.
- Moving in: Your stand will be ready for you at 13:00 on 3/12. You may work in your stand until 22:00.
- Moving out: moving out before closing time 16:30 is not permitted.
- Exhibition opening hours: 4 December 09.00–16.30

Visitors

The expected number of visitors in Malmö is 6,000, quite evenly distributed over the three slot times 9.00–11.30, 11.30–14.00 and 14.00–16.30.

Checklist, don't miss this! Read more below.

- ☐ Make sure your digital presentation is up to date, don't forget key words and fields of interest for searchability.
- ☐ Entrance outside of the exhibitions opening hours is at the goods entrance, at the back end of the building. [Google maps link](#)
- ☐ Pick up exhibitor badge at the entrance. State your exhibitor name and stand no.
- ☐ [Read practical information from Malmö Exhibitor Service](#)

Please note!

- ☐ Need assistance on site? Go to Servicecenter, see sign in the far left end of the exhibition hall.
- ☐ Distribution of leaflets outside your stand area is not permitted.

More

- **Info from the exhibition facilities, check-in and check-out times, goods addresses, delivery of goods, etc**
[Read exhibitor information from Malmö Exhibitor Service](#). If anything differs from the content of this document, our information applies.
- **Digital presentation**
Create/update your digital presentation in the digital fair guide Sacomässan.se if you have not done so already. Check formatting, NOTE! that we have introduced a maximum of 900 characters incl. blank space. Be sure to click in relevant areas of interest and add keywords for Searchability (under Digital in the left menu).

- **Exhibitor cloak room**

Free exhibitor cloak room, show your exhibitor badge from 08.00 during the fair day. The arrows show the entrances to the exhibition hall at Kistamässan.

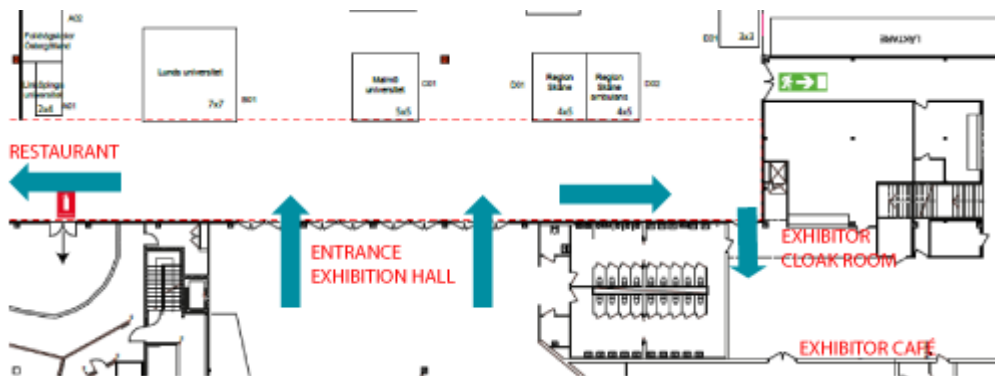

- **Exhibitor restaurant**

The exhibitor restaurant is to the left when entering the exhibition hall. Opening hours are 11:15 – 14:00.

- **Exhibitor café**

Exhibitor café is opposite to the exhibitor cloak room, see illustration above.

- **Stand location**

[See floor plans in Q&A for exhibitors](#)

- **Exhibitor badges**

Pick up your badges either at the goods entrance when you arrive, this is located at the back end of the building. The main entrance is only open during the exhibition's opening hours. 9:00 – 16:30.

- **Wifi**

Exhibitor wifi is Saco exhibitor, password: hejasaco2024