



Important infos for Saco Student Fair in Stockholm 2024

Hours

- Moving in: Your stand will be ready for you at 13:00 on 26/11. You may work in your stand until 22:00.
- Moving out: moving out before closing time 16:30 is not permitted.
- Exhibition opening hours: 27 November 09.00–16.30

Visitors

The expected number of visitors in Stockholm is 22,000, quite evenly distributed over the three slot times 9.00–11.30, 11.30–14.00 and 14.00–16.30 over the two days.

Checklist, don't miss this! Read more below.

- ☐ Make sure your digital presentation is up to date, don't forget key words and fields of interest for searchability.
- ☐ Entrance outside of the exhibitions opening hours is at the goods entrance, Våtgöatan 3. [Link Google maps](#)
- ☐ Pick up exhibitor badge at the entrance. State your exhibitor name and stand no.
- ☐ Read [practical information from Kistamässan](#)

Please note!

- ☐ Need assistance on site? Go to Servicecenter, just outside the exhibition hall.
- ☐ Distribution outside your stand area is not permitted.
- ☐ Leaving your stand before closing hours is not permitted.

More

- **Info from the exhibition facilities, check-in and check-out times, goods addresses, delivery of goods, etc**
[Read exhibitor information from Kista Exhibitor Service](#). If anything differs from the content of this document, our information applies.
- **Digital presentation**
Create/update your digital presentation in the digital fair guide Sacomässan.se if you have not done so already. Check formatting, NOTE! that we have introduced a maximum of 900 characters incl. blank space. Be sure to click in relevant areas of interest and add keywords for Searchability (under Digital in the left menu).

- **Exhibitor cloak room**

Free exhibitor cloak room, show your exhibitor badge from 08.00 during the fair day. The arrows show the entrances to the exhibition hall at Kistamässan.

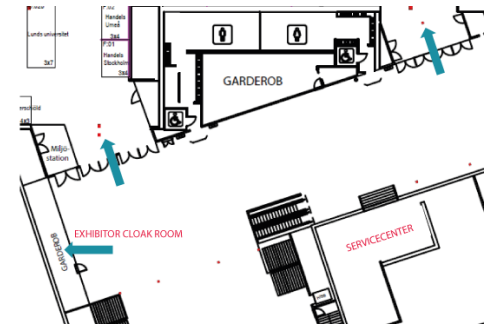

- **Exhibitor restaurant**

Exhibitor badge is mandatory. There are two exhibitors restaurants, one just outside the exhibition hall and one as shown in this illustration.

Comin in through the right side entrance to the exhibition hall – turn right and then follow the arrows.

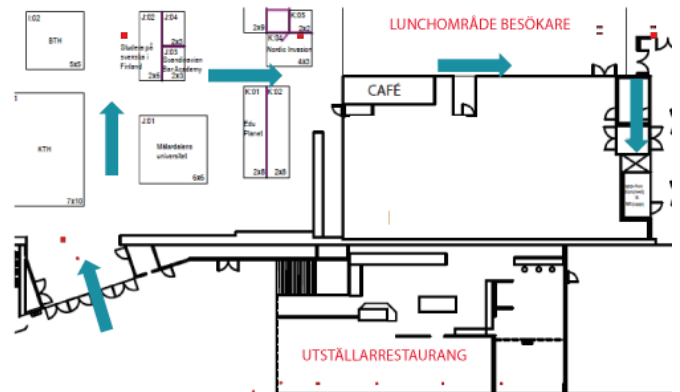

- **Exhibitor café**

Exhibitor badge is mandatory. Exhibitors in Stockholm can have coffee for free in E10, which is located downstairs by the E halls where the lectures are held. See sign at the stairs in the upper entrance..

- **Stand location**

[See floor plans in Q&A for exhibitors](#)

- **Exhibitor badges**

Pick up your badges either at the goods entrance when you arrive. The main entrance is only open during the exhibition's opening hours. 9:00 – 16:30.

- **Wifi**

Exhibitor wifi is Saco exhibitor, password: hejasaco2024